



## Application Note - AN-80i Video Surveillance Backhaul Solution



Redline's RedCONNEX™ family of broadband wireless infrastructure solutions are used worldwide to address the need for backhauling video surveillance data. Organizations responsible for homeland security and other essential emergency response activities need robust and reliable networks that can deliver real time video data for safety, security in various areas of their operations. These organizations include police and fire departments responsible, in part, for public safety and homeland security, forest and public park services, businesses and retail environments with anti-theft and security monitoring systems, or even news stations that need to provide around-the-clock video coverage of unfolding events.

These organizations are being challenged to install video surveillance in remote locations that are physically hard to reach, or too expensive to connect via traditional leased lines or fiber. When unforeseen events and critical events arise, there may simply not be enough time to install landlines for video broadcast.

Wireless broadband is the answer that meets the needs of organizations requiring real-time video surveillance capabilities.

### Redline's AN-80i Advantage

Redline's AN-80i is a robust broadband wireless backhaul product that offers a point-to-point solution that can be quickly and easily set up and deployed. The AN-80i over-comes physical and geographical boundaries to transmit real-time video and data from one remote location to an organization's central or control office at distances of up to 80 km (50 miles).

The AN-80i's simplified installation and management, gives organizations the power to easily set up a virtually unlimited number of units, even in the most difficult urban locations and rough terrains. Unlike wireline connections, the AN-80i can be relocated and redeployed quickly to where they are needed - with minimal added expense.

The AN-80i provides organizations with the tools they need for remote video surveillance to cover areas spanning a few square meters to areas encompassing thousands of square kilometers. Weather resistant to the most extreme high and low temperatures, AN-80i can be installed in under a day to deliver the security and protection you need, when you need it.

Leveraging its enhanced security mechanisms and a 64-bit key encryption scheme, AN-80i ensures that the surveillance information is always reliably and securely transmitted. The AN-80i is the ideal solution for the delivery of real-time, sensitive video and data transmission for both government and private organizations.

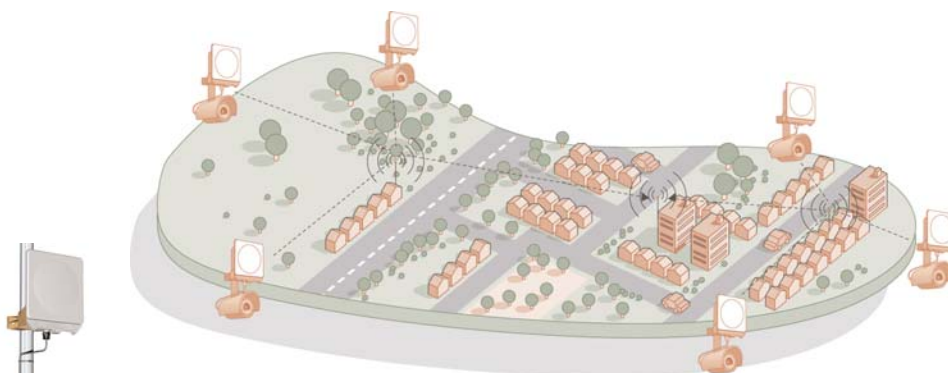

Redline's AN-80i is ideal for wireless video surveillance coverage and backhaul distribution solutions.

SETTING THE STANDARD FOR ADVANCED BROADBAND WIRELESS

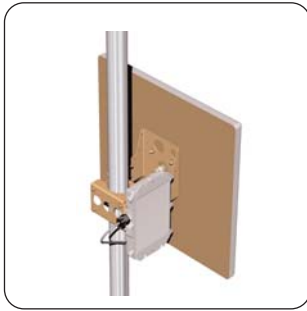

Available via:

### Key Features

- Industry leading BER of 10<sup>-9</sup>, exceeding carrier-class reliability specifications
- Adaptive modulation/coding with 8 levels from BPSK to 64QAM
- Proprietary ARQ algorithm with advanced FEC for 99.999% link availability
- Extremely low latency (1-2 ms)
- High spectral efficiency dynamic adaptive TDD and ARQ
- High throughput PTP, PMP
- Universal support for 5.4 and 5.8 GHz bands
- Software selectable channels at 2.5 MHz increments with 10, 20 and 40MHz channel size
- Mode/speed fully software upgradeable
- Built on proven, reliable OFDM technology

### Strategic Benefits

- Provides unmatched reliability, security and flexibility
- Delivers unrivaled capacity and range
- Performance leader with 90 Mbps Ethernet data rate
- Cost-effective, secure and robust backhaul of video surveillance and voice data traffic
- Delivers robust performance in low-profile and non line-of-site-conditions
- Ease of installation, relocation and redeployment
- Reduces the cost of providing high speed data links between remote-locations
- Ensures enhanced over-the-air data transfer using highly-secure 64-bit encryption schemes

### Wireless Advantage

Broadband wireless allows any security organization to rapidly set up advanced communications and video surveillance equipment where it is needed most- in difficult urban or remote locations. They also provide very inexpensive, redundant links to carry voice and data traffic to meet today's demanding business continuity needs. Furthermore, Redline's wireless equipment can be repositioned or redeployed without having to re-route the backhaul connection.

Designed for high performance and reliability in real world environments, the AN-80i is the industry's most advanced multi-service wireless Ethernet bridge. The AN-80i delivers unmatched capacity, range, reliability, low latency and ease of use to support both backhaul and access applications. It is the ideal choice for companies that require a cost-effective carrier-grade solution that supports today's advanced applications including transparent LAN, VoIP and high-quality video.

### About Redline Communications

Redline Communications is the leading provider of standards-based wireless broadband solutions. Redline's RedMAX™ WiMAX Forum Certified™ systems and award-winning RedCONNEX™ family of broadband wireless infrastructure products enable service providers and other network operators to cost-effectively deliver high-bandwidth services including voice, video and data communications.

Redline is committed to maintaining its wireless industry leadership with the continued development of WiMAX and other advanced wireless broadband products. With more than 35,000 installations in 75 countries, and a global network of over 100 partners, Redline's experience and expertise helps service providers, enterprises and government organizations roll out the services and applications that drive their business forward.

SETTING THE STANDARD FOR ADVANCED BROADBAND WIRELESS